

PRODUCT DETAIL

INSTALLATION DETAIL / Cross Section

PF.2

"J" MOLDING

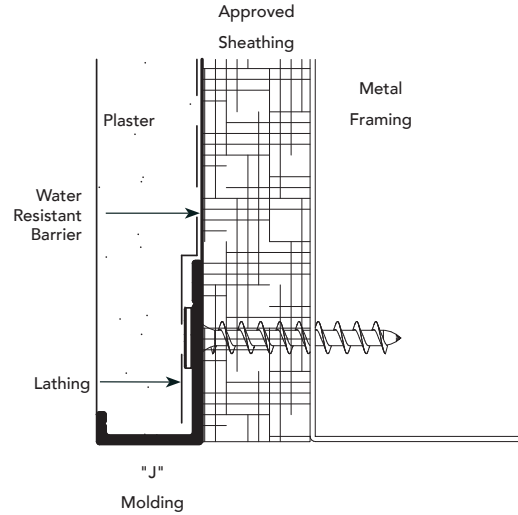
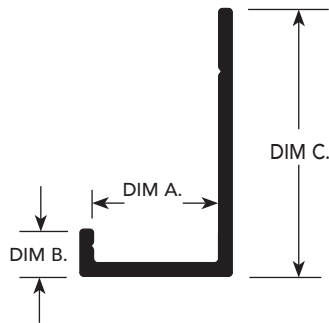

USAGE

Fry Reglet "J" Molding is a basic interior or exterior trim used to terminate and finish plaster, stucco, drywall or wood panels.

GUIDE SPECIFICATION

Where indicated on drawings, Fry Reglet "J" Molding, as manufactured by Fry Reglet Corporation, shall be installed. Aluminum shall be extruded alloy 6063 T5, with chemical conversion coating, clear anodized or other specified finish. Refer to finish section.

SIZES

DIM. A	DIM. B	DIM. C	NUMBER
1/2"	3/16"	1 1/8"	JDM-50
1/2"	1/2"	1 3/4"	JDM-50-50
5/8"	3/16"	1 1/8"	JDM-625
3/4"	3/16"	1 1/8"	JPM-75
3/4"	3/16"	3"	JPM-75-300
1"	3/16"	1 1/8"	JPM-100

Weep holes available upon request