

**DA.5**

**PRODUCT DETAIL**

**REVEAL  
BASE**

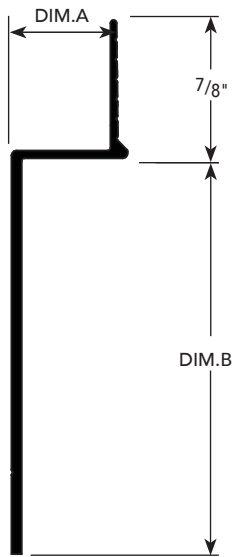

**INSTALLATION DETAIL / Cross Section**

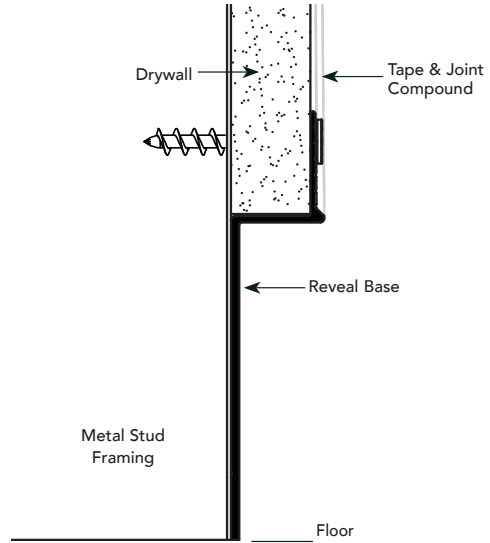

**USAGE**

Fry Reglet Reveal Base is used at bottom of wall to form an attractive, damage-resistant recessed base.

**GUIDE SPECIFICATION**

Where indicated on drawings, Fry Reglet Reveal Base, as manufactured by Fry Reglet Corporation, shall be installed. Aluminum shall be extruded alloy 6063 T5, with chemical conversion coating, clear anodized or other specified finish. Refer to finish section.

**INSTALLATION DETAIL / ISO View**

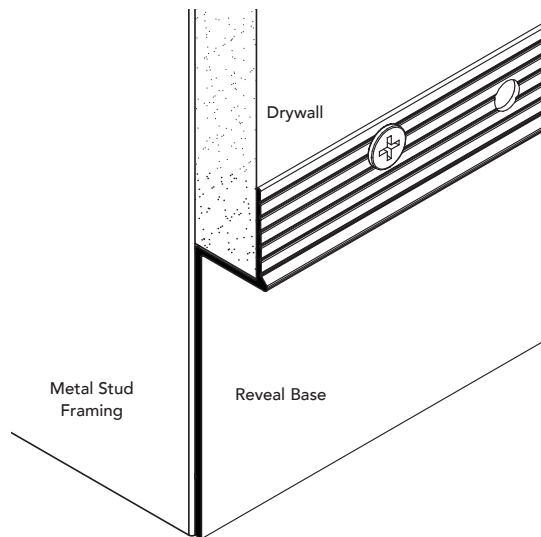

**SIZES**

| DIM. A<br>REVEAL<br>DEPTH | DIM. B<br>REVEAL<br>HEIGHT | NUMBER       |
|---------------------------|----------------------------|--------------|
| 1/2"                      | 4"                         | DRMB-50-400  |
| 5/8"                      | 2 1/2"                     | DRMB-625-250 |
| 5/8"                      | 3"                         | DRMB-625-300 |
| 5/8"                      | 4"                         | DRMB-625-400 |
| 5/8"                      | 6"                         | DRMB-625-600 |