

PRODUCT DETAIL

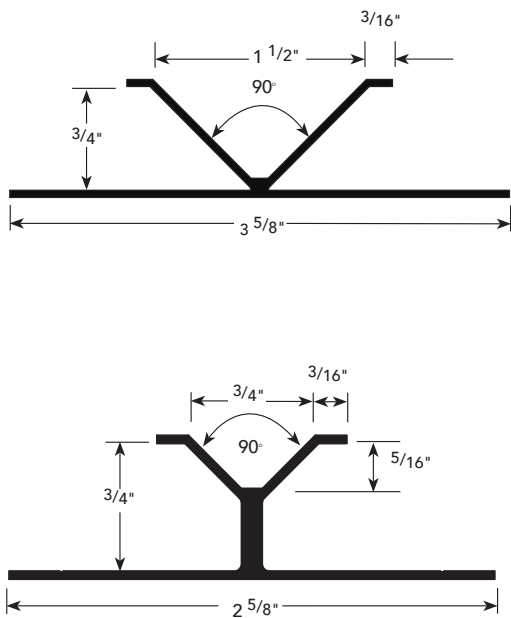

INSTALLATION DETAIL / Cross Section

PA.3

"V" REVEAL MOLDING

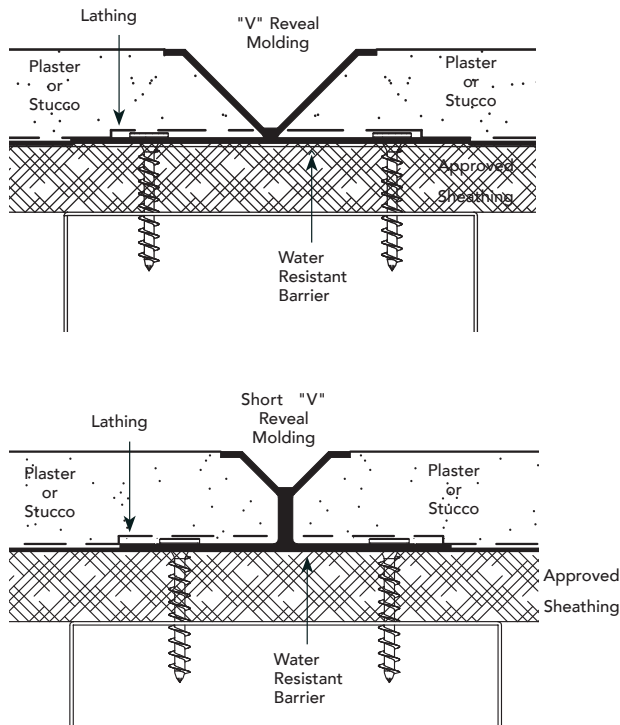

USAGE

Fry Reglet "V" Reveal Molding creates a "V" shaped reveal in conventional lath and plaster applications that emulates the appearance of the vertical joint in pre-cast or tilt-up panels. Can be used vertically or horizontally and where new plaster construction is installed adjacent to tilt-up construction. Used to maintain panelized appearance throughout the project.

GUIDE SPECIFICATION

Where indicated on drawings, Fry Reglet "V" Reveal Molding, as manufactured by Fry Reglet Corporation, shall be installed. Aluminum shall be extruded alloy 6063 T5, with chemical conversion coating, clear anodized or other specified finish. Refer to finish section.

SIZES

REVEAL DEPTH	REVEAL WIDTH	NUMBER
3/4"	1 1/2"	PCSV-75
5/16"	3/4"	PCSV-75-Short