

"T" MOLDING

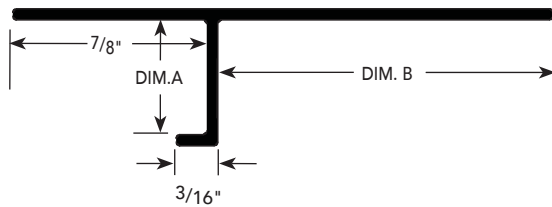

INSTALLATION DETAIL / Cross Section

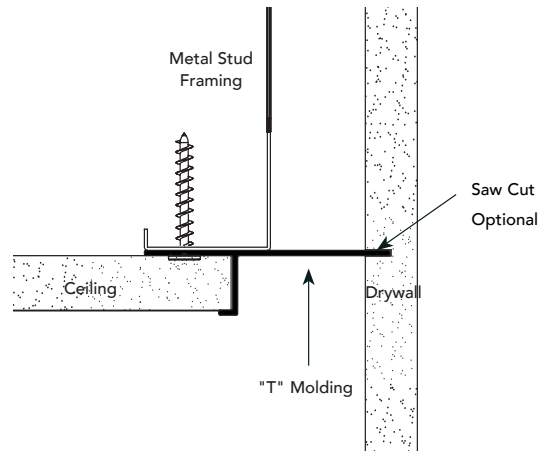

USAGE

Fry Reglet "T" Molding creates a reveal at wall/ceiling intersection, provides a clean edge for ceiling and finishes ceiling edge with no need for taping and spackling. Available vented where air flow into ceiling plenum is desired.

GUIDE SPECIFICATION

Where indicated on drawings, Fry Reglet "T" Molding, as manufactured by Fry Reglet Corporation, shall be installed. Aluminum shall be extruded alloy 6063 T5, with chemical conversion coating, clear anodized or other specified finish. Refer to finish section.

INSTALLATION DETAIL / ISO View

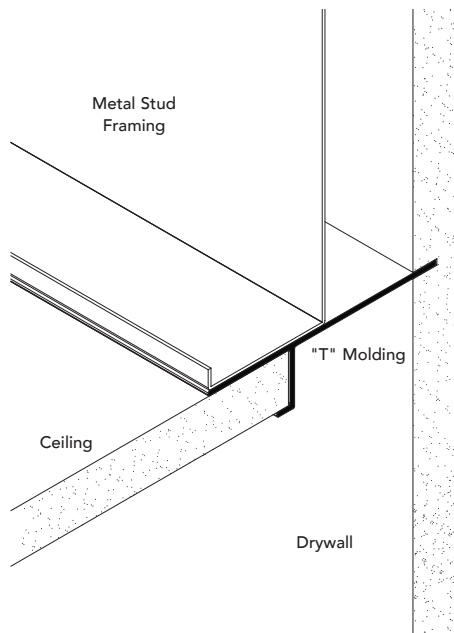

SIZES

DA.13

"T" MOLDING

DIM. A REVEAL DEPTH	DIM. B REVEAL WIDTH	NUMBER	
		NON-VENTED	VENTED
1/2"	1/2"	TDM-50-50	TDM-50-V-50
1/2"	3/4"	TDM-50-75	TDM-50-V-75
1/2"	1 1/8"	TDM-50-1125	TDM-50-V-1125
1/2"	1 1/2"	TDM-50-150	TDM-50-V-150
5/8"	1/2"	TDM-625-50	TDM-625-V-50
5/8"	3/4"	TDM-625-75	TDM-625-V-75
5/8"	1 1/8"	TDM-625-1125	TDM-625-V-1125